

Material
 Screw: M2.5, Steel, Zn plated
 Cage: Stainless steel
 Pin header: Brass, Tin plated
 Housing: LCP, UL94V-0

Electrical
 Rated voltage: 300V
 Rated current: 16A
 Wire range: 22~14AWG 1.5mm²
 Contact Resistance: 20 mΩ
 Insulation resistance: 1 MΩ
 Withstand voltage: AC1600V / 1 min

Mechanical
 Temp. Range: -40 °C ~ +115 °C
 Soldering: 265 °C ±10 °C 5Sec. Max.
 Torque: 0.4 N.m (3.5 Lb. in)
 Strip length: 5~6mm

Order Information

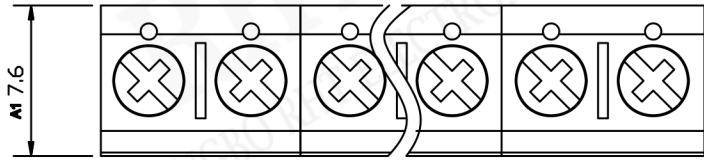
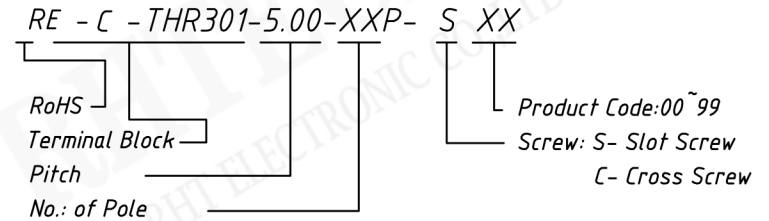

N=Number of poles
 DimA=N*5.0
 DimB=(N-1)*5.0

Dim Poles	Dim A	Dim B
2-6P	±0.15	±0.10
7-12P	±0.20	±0.20
13-18P	±0.30	±0.25
19-24P	±0.40	±0.30

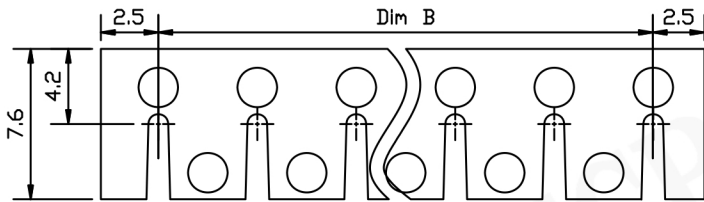

Bottom VIEW

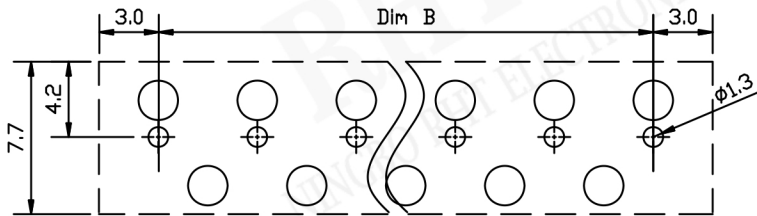

PCB LAYOUT



NINGBO RHT ELECTRONIC CO.,LTD

UNITS:mm	SHEET SIZE:A4		SCALE: ---	First angle projection
> 0 ~ 3	> 3 ~ 18	> 18 ~ 50	> 50 ~ 120	
± 0.12	± 0.15	± 0.3	± 0.5	TERMINAL BLOCK