

PCB LAYOUT

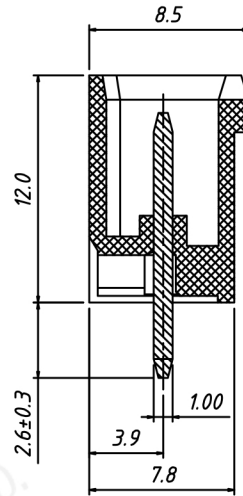

SECTION A-A

Material

Nut: M2.5, Brass
 Pin header: Brass, Tin plated
 Housing: LCP, UL94V-0, Black



Electrical

Rated voltage: 300V
 Rated current: 15A
 Contact Resistance: 20 mΩ
 Insulation resistance: 500MΩ/DC500V
 Withstand voltage: AC2000V / 1 min

Mechanical

Temp. Range: -40 °C ~ +130 °C
 Soldering: 285 °C ± 5 °C for 10S

Order Information

RE - C - THREDVM - 5.08 - XXP - S XX

RoHS ———
 Terminal Block ———
 Pitch ———
 No.: of Pole ———

Product Code: 00 ~ 99
 Screw: S - Slot Screw
 C - Cross Screw



NINGBO RHT ELECTRONIC CO.,LTD

UNITS:mm

SHEET SIZE:A4

SCALE: ---

> 0 ~ 3

> 3 ~ 18

> 18 ~ 50

> 50 ~ 120

± 0.12

± 0.15

± 0.3

± 0.5

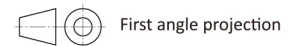

First angle projection

TERMINAL BLOCK