

P/N:RE-C-SIM-010A

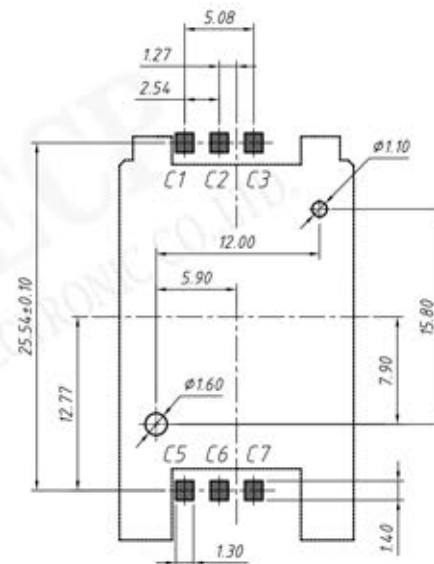

Reference PCB layout
Unit:mm tolerance:±0.05

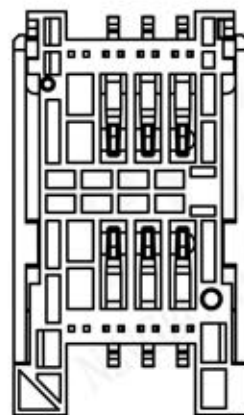
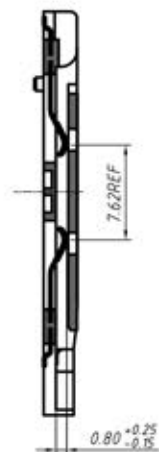
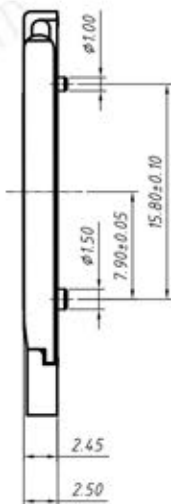
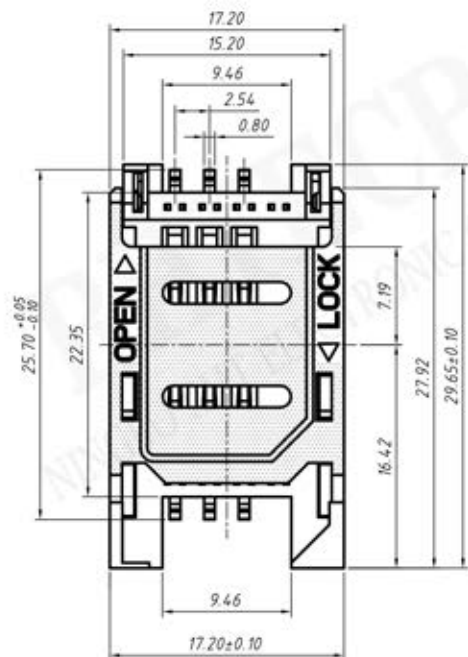
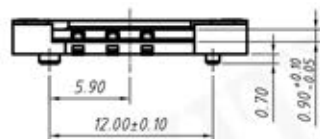

Electrical:

Current Rating:0.5A.

Dielectric Withstanding Voltage:500V AC

Insulation Resistance:1000M Ω Min

Contact Resistance:30m Ω Max.

Life:10000 Cycles

Operating Temperature: -45°C ~ +105°C

Material:

Insulator body:LCP. Color:Black

Contact:Phosphor Bronze

Plating:

Finsh: Tin Gold or Duplex plated.

Standard:Gold flash all over Nickel

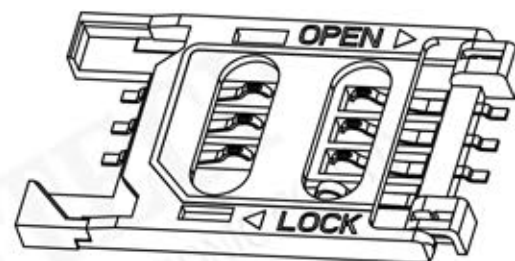

P/N:RE-C-SIM-010A

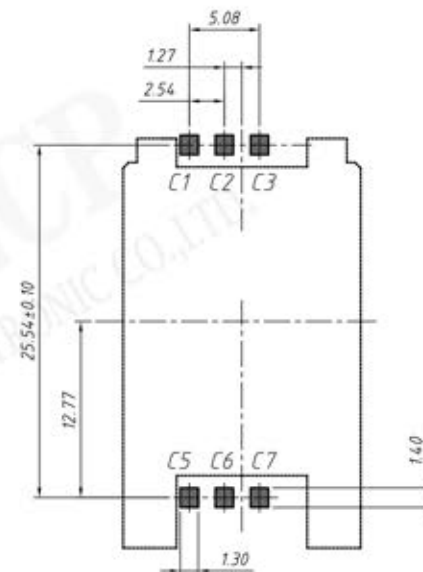
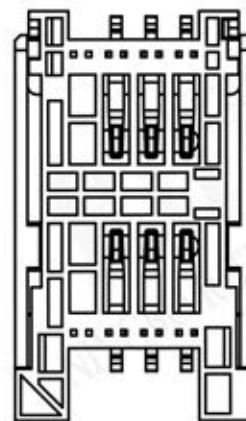
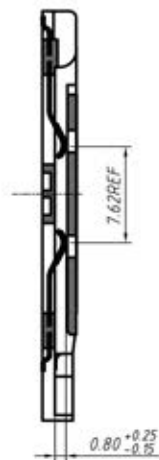
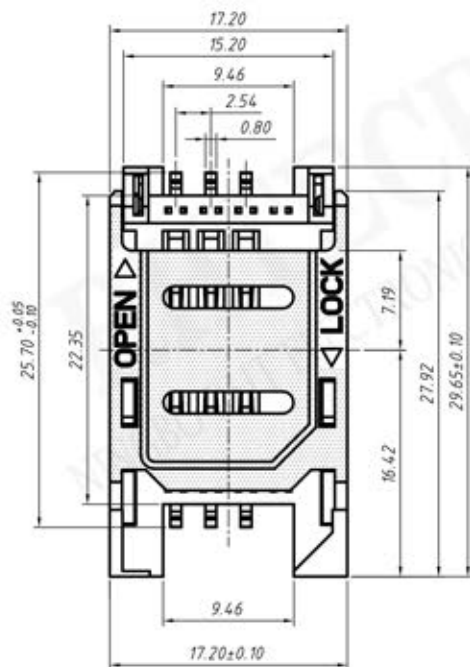

Reference PCB layout
Unit:mm tolerance:±0.05



Electrical:

Current Rating:0.5A.
Dielectric Withstanding Voltage:500V AC
Insulation Resistance:1000M Ω Min
Contact Resistance:30m Ω Max.
Life:10000 Cycles
Operating Temperature: -45 $^{\circ}$ C ~ +105 $^{\circ}$ C

Material:

Insulator body:LCP. Color:Black
Contact:Phosphor Bronze
Plating:
Finish:Tin Gold or Duplex plated.
Standard:Gold flash all over Nickel

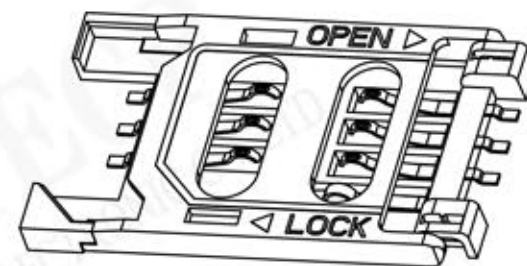

P/N:RE-C-SIM-010A

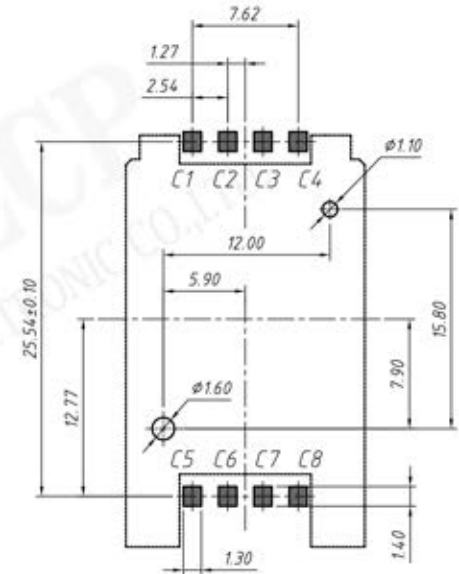
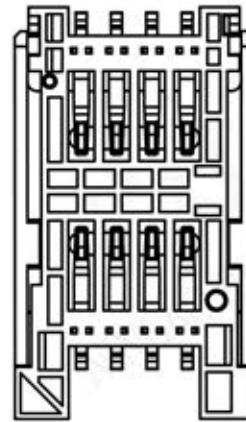
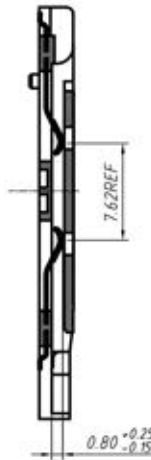
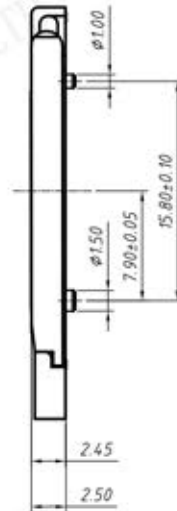
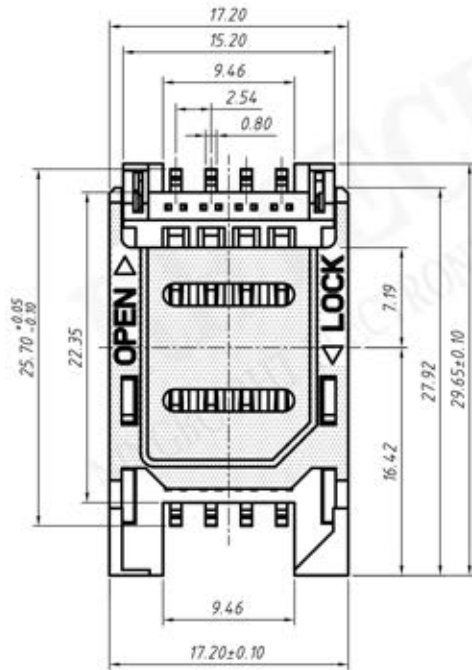

Reference PCB layout
Unit:mm tolerance:±0.05

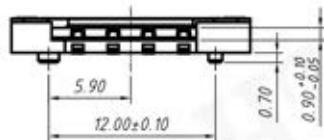

Electrical:
 Current Rating:0.5A.
 Dielectric Withstanding Voltage:500V AC
 Insulation Resistance:1000M Ω Min
 Contact Resistance:30m Ω Max.
 Life:10000 Cycles
 Operating Temperature: -45°C ~ +105°C

Material:
 Insulator body:LCP. Color:Black
 Contact:Phosphor Bronze
 Plating:
 Finish: Tin Gold or Duplex plated.
 Standard:Gold flash all over Nickel

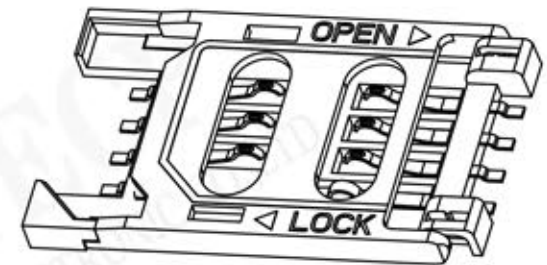

P/N:RE-C-SIM-010A

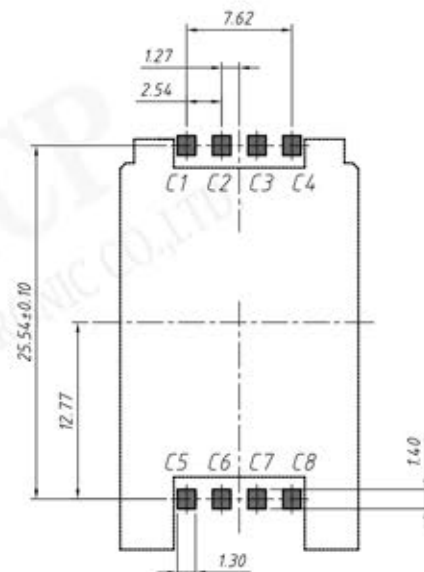
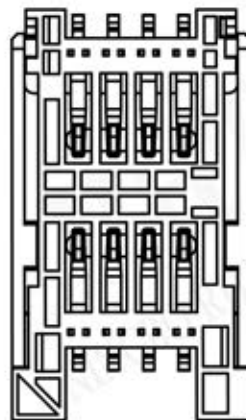
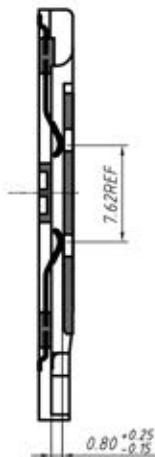
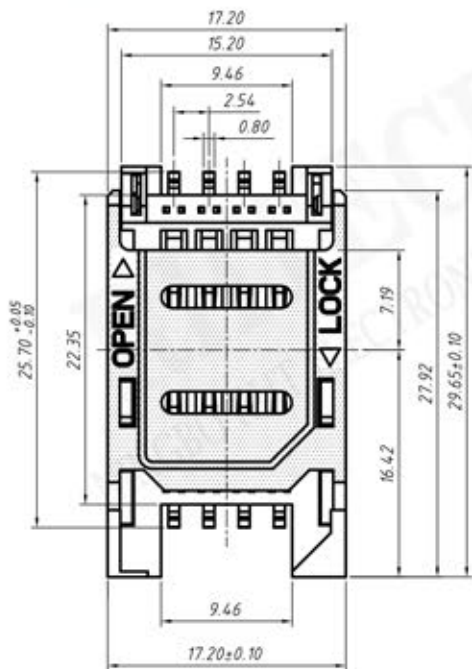

Reference PCB layout
Unit:mm tolerance:±0.05

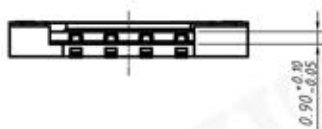

Electrical:

Current Rating:0.5A.
Dielectric Withstanding Voltage:500V AC
Insulation Resistance:1000M Ω Min
Contact Resistance:30m Ω Max.
Life:10000 Cycles
Operating Temperature: -45°C ~ +105°C

Material:
Insulator body:LCP. Color:Black
Contact:Phosphor Bronze
Plating:
Finish: Tin Gold or Duplex plated.
Standard:Gold flash all over Nickel

