

P/N: RE-C-TF-018

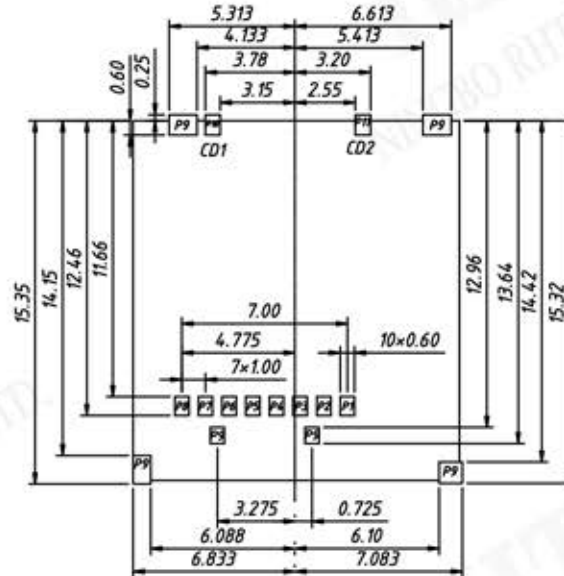
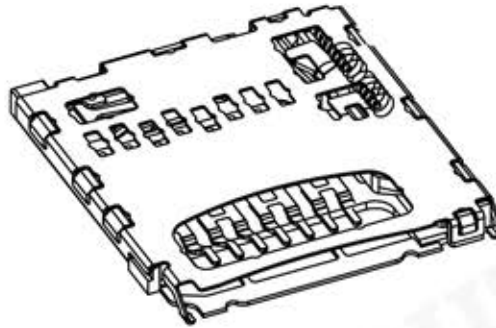
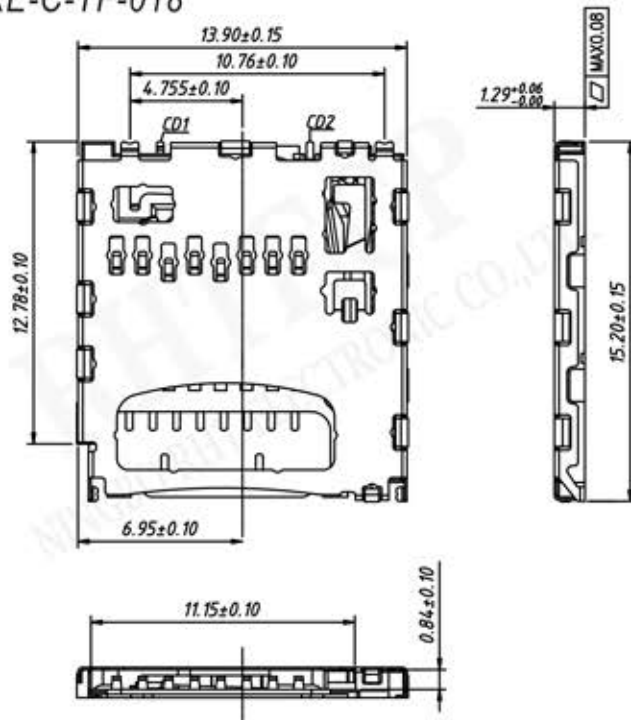

PCB LAYOUT

PIN ASSIGNMENTS

PIN NO.	NAME	DESCRIPTION
1 #	DAT2	Data Line(Bit 2)
2 #	CD/DAT3	Card Detect/Data line(Bit 3)
3 #	CMD	Command/Response
4 #	VDD	Supply voltage
5 #	CLK	Clock
6 #	VSS	Supply voltage ground
7 #	DAT0	Data Line (Bit 0)
8 #	DAT1	Data Line (Bit 1)

Material:

Insulator:LCP,UL 94 V-0,Black.

Slide:LCP,UL 94 V-0,Black.

Latch:Phosphor Bronze.

Contact:Phosphor Bronze.

Shell:SUS304

Spring:Stainless Steel.

Crank-axle:Stainless Steel.

Electrical:

Voltage:100V AC

Current:0.5A Max.

Contact Resistance:40mΩ Max.

Voltage Proof::500V AC

Insulation Resistance:1000MΩ Min.

Card Insertion/Withdrawal Force:10N Max.

Push in strength:10N

Durability:10000 Cycles.

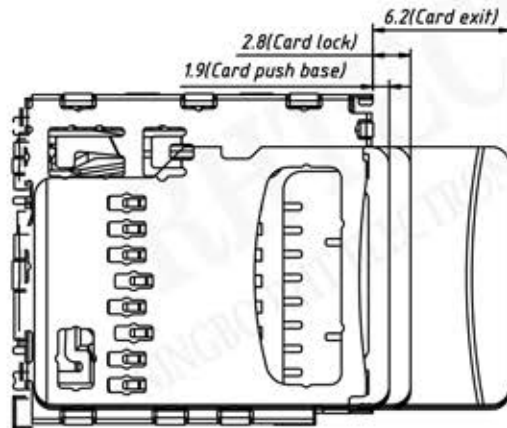

CARD INSERT LAYOUT