

**Material:**  
 Housing: PBT+Glass Filled Polyester  
 Flammability Rating: UL94V-0  
 Contacts: Phosphor Bronze  $\phi 0.46\text{mm}$   
 Plating: Gold Plating  
 PEG: Steel, Tin Plating

**Electrical:**  
 Voltage Rating: 125VAC  
 Current Rating: 1.5A  
 Contact Resistance:  $30\text{m}\Omega$  Max.  
 Insulation Resistance:  $500\text{M}\Omega$  Min.  
 Dielectric Strength: 1000VAC Rms 50Hz, 1 Min.  
 Durability: 600 cycles Min.  
 Operation Temperature:  $-40^{\circ}\text{C} \sim +70^{\circ}\text{C}$

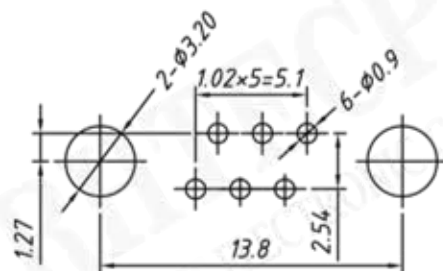

PCB Layout

**Order Information**

RE-C-303-6P6C-1x1-1-1-XX-B

Contacts: 6P6C  
 Peg Code: 1-With IRON PEG  
 Insert Angle: 1-90°(Right angle)  
 Plating Code:  
 01-Fu" Gold Plating  
 02-3u" Gold Plating  
 03-6u" Gold Plating  
 04-15u" Gold Plating  
 05-30u" Gold Plating  
 Color Code: B-Black  
 G-Gray



NINGBO RHT ELECTRONIC CO.,LTD

UNITS:mm

SHEET SIZE:A4

SCALE:---

>0~3

>3~18

>18~50

>50~120

RE-C-303-6P6C-1x1-1-1-XX-B

±0.12

±0.15

±0.3

±0.5

CONNECTORS

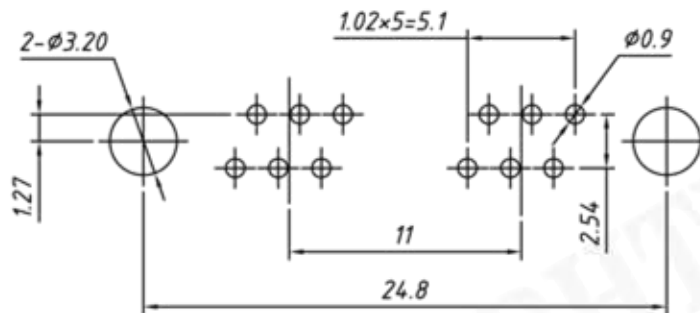
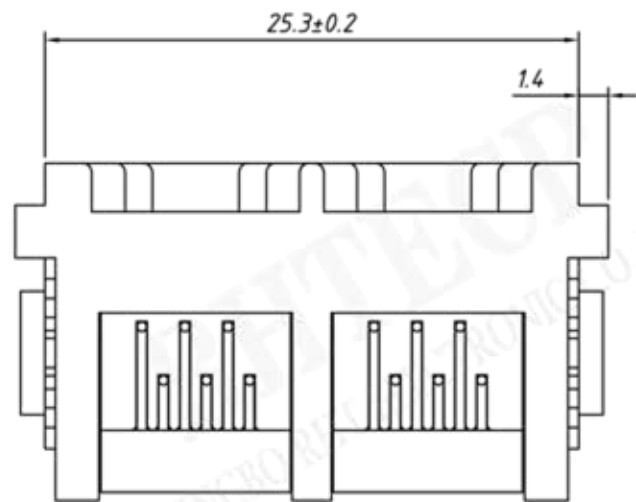

PCB Layout

**Material:**  
**Housing:** PBT+Glass Filled Polyester  
**Flammability Rating:** UL94V-0  
**Contacts:** Phosphor Bronze ∅0.46mm  
**Plating:** Gold Plating  
**PEG:** Steel, Tin Plating

**Electrical:**  
**Voltage Rating:** 125VAC  
**Current Rating:** 1.5A  
**Contact Resistance:** 30mΩ Max.  
**Insulation Resistance:** 500MΩ Min.  
**Dielectric Strength:** 1000VAC Rms 50Hz, 1 Min.  
**Durability:** 600 cycles Min.  
**Operation Temperature:** -40°C ~ +70°C

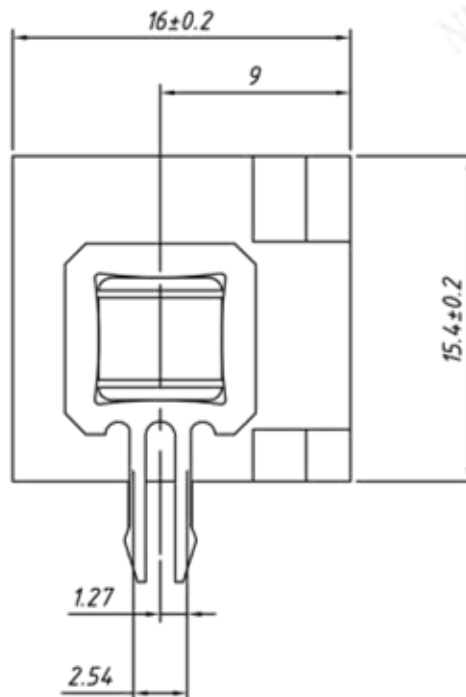
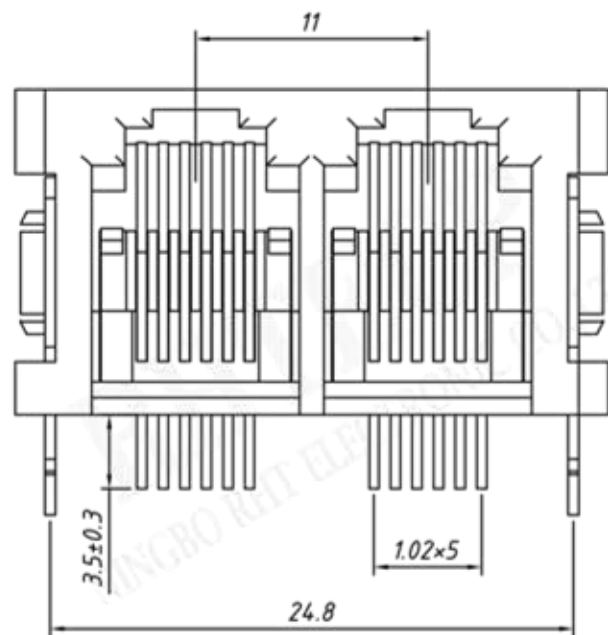

**Order Information**

RE-C-303-6P6C-1x2-1-1-XX-B

**Contacts:** 6P6C  
**Peg Code:** 1-With IRON PEG  
**Insert Angle:** 1-90°(Right angle)  
**Plating Code:**  
 01-Fu" Gold Plating  
 02-3u" Gold Plating  
 03-6u" Gold Plating  
 04-15u" Gold Plating  
 05-30u" Gold Plating  
**Color Code:** B-Black  
 G-Gray

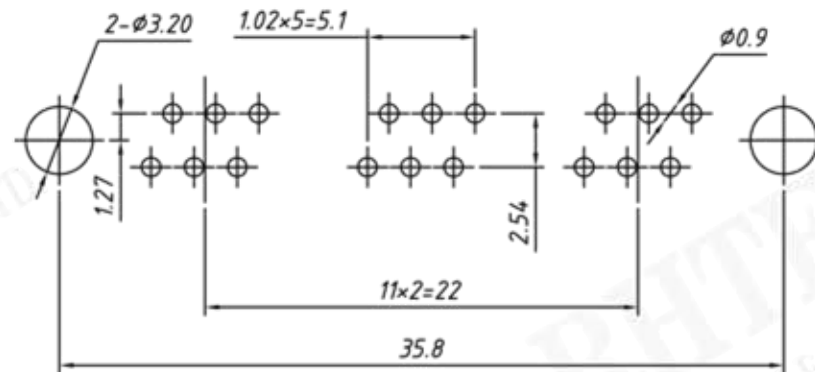
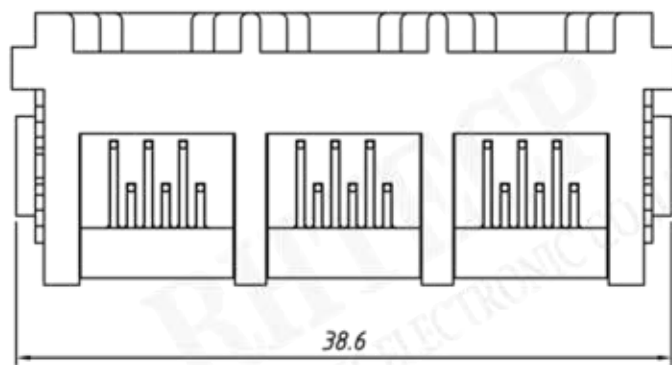

PCB Layout

**Material:**  
**Housing:** PBT+Glass Filled Polyester  
**Flammability Rating:** UL94V-0  
**Contacts:** Phosphor Bronze Ø0.46mm  
**Plating:** Gold Plating  
**PEG:** Steel, Tin Plating

**Electrical:**  
**Voltage Rating:** 125VAC  
**Current Rating:** 1.5A  
**Contact Resistance:** 30mΩ Max.  
**Insulation Resistance:** 500MΩ Min.  
**Dielectric Strength:** 1000VAC Rms 50Hz, 1 Min.  
**Durability:** 600 cycles Min.  
**Operation Temperature:** -40°C ~ +70°C

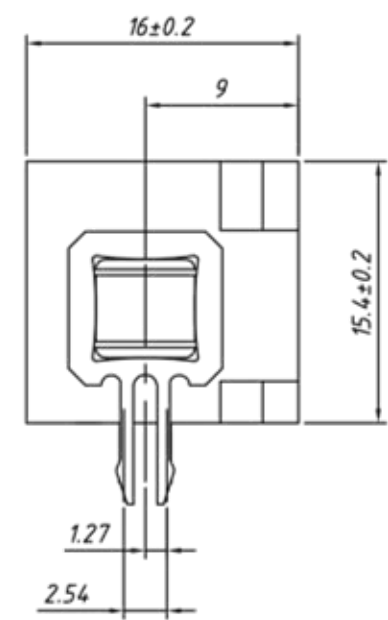
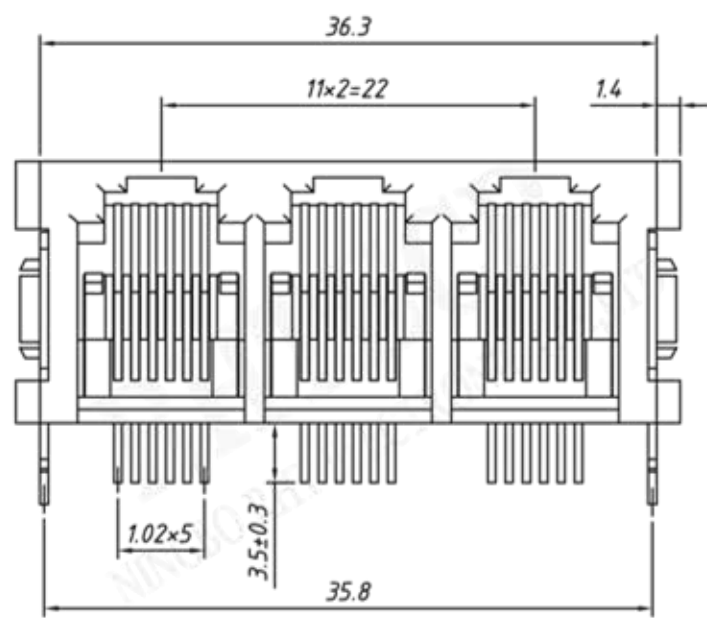

Order Information

RE-C-303-6P6C-1x3-1-1-XX-B

**Contacts:** 6P6C  
**Peg Code:** 1-With IRON PEG  
**Insert Angle:** 1-90°(Right angle)  
**Plating Code:**  
 01-Fu" Gold Plating  
 02-3u" Gold Plating  
 03-6u" Gold Plating  
 04-15u" Gold Plating  
 05-30u" Gold Plating  
**Color Code:** B-Black  
 G-Gray

UNITS:mm	SHEET SIZE:A4		SCALE:---
>0~3	>3~18	>18~50	>50~120
±0.12	±0.15	±0.3	±0.5

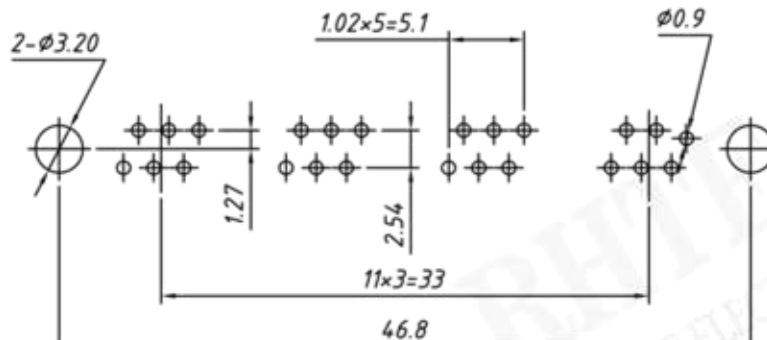
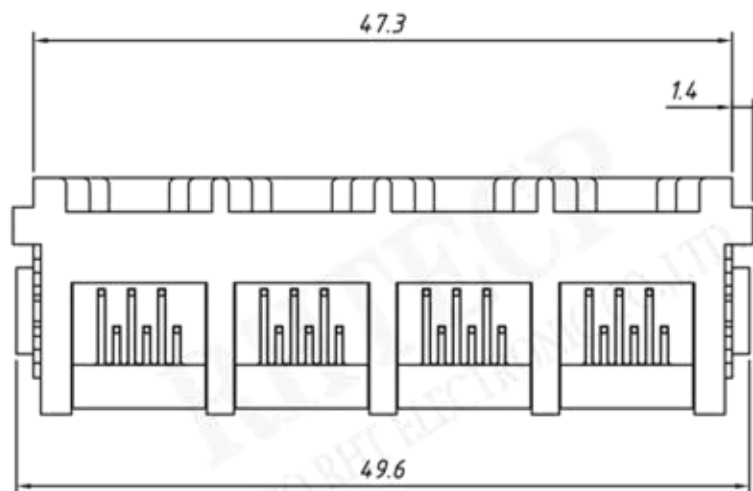

PCB Layout

Material:  
 Housing: PBT+Glass Filled Polyester  
 Flammability Rating: UL 94V-0  
 Contacts: Phosphor Bronze  $\phi 0.46\text{mm}$   
 Plating: Gold Plating  
 PEG: Steel, Tin Plating

Electrical:  
 Voltage Rating: 125VAC  
 Current Rating: 1.5A  
 Contact Resistance:  $30\text{m}\Omega$  Max.  
 Insulation Resistance:  $500\text{M}\Omega$  Min.  
 Dielectric Strength: 1000VAC Rms  
 50Hz, 1 Min.  
 Durability: 600 cycles Min.  
 Operation Temperature:  $-40^{\circ}\text{C} \sim +70^{\circ}\text{C}$

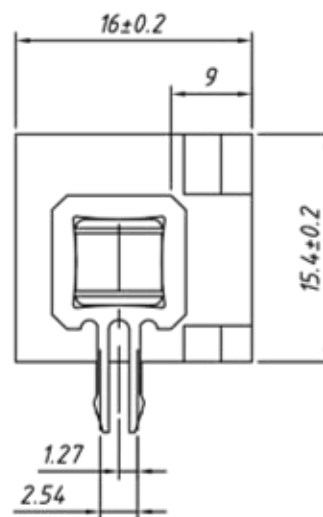
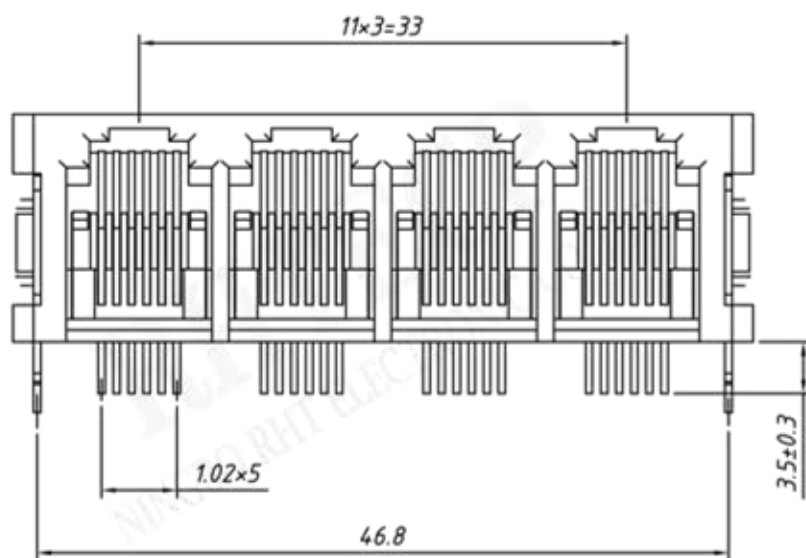

Order Information

RE-C-303-6P6C-1x4-1-1-XX-B

Contacts: 6P6C  
 Peg Code: 1-With IRON PEG  
 Insert Angle: 1-90°(Right angle)  
 Plating Code:  
 01-1u" Gold Plating  
 02-3u" Gold Plating  
 03-6u" Gold Plating  
 04-15u" Gold Plating  
 05-30u" Gold Plating  
 Color Code: B-Black  
 G-Gray



NINGBO RHT ELECTRONIC CO.,LTD

UNITS:mm

SHEET SIZE:A4

SCALE:---

>0~3

>3~18

>18~50

>50~120

RE-C-303-6P6C-1x4-1-1-XX-B

±0.12

±0.15

±0.3

±0.5

CONNECTORS

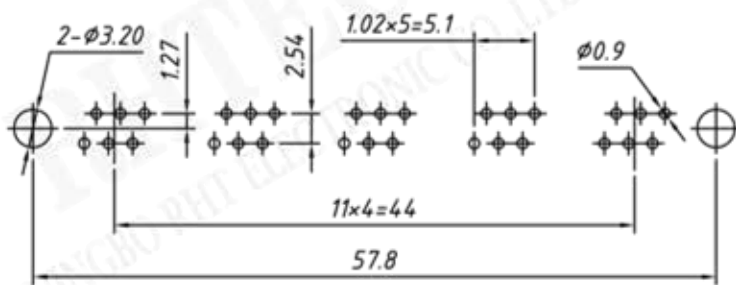
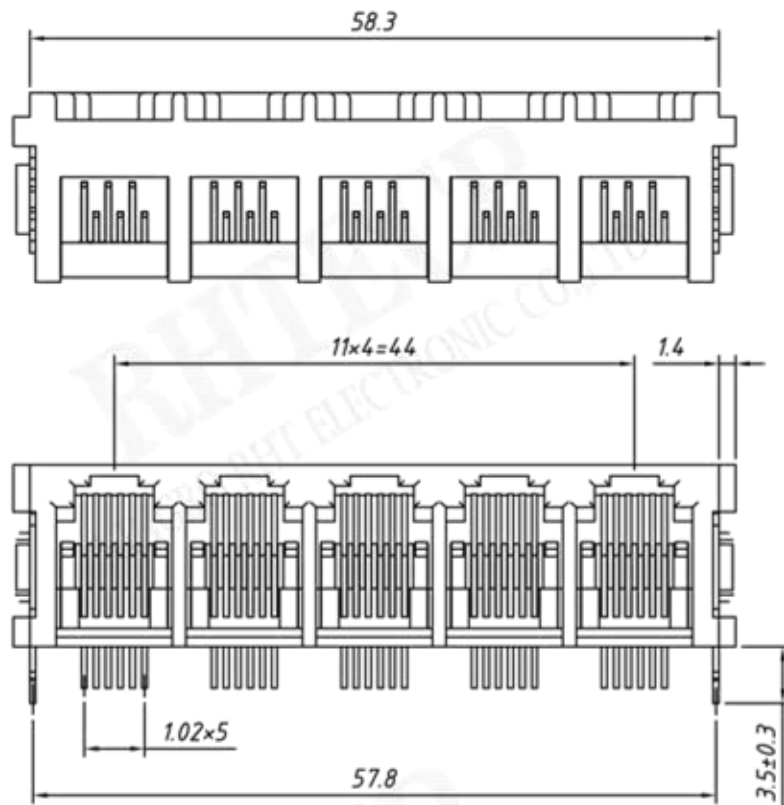

PCB Layout

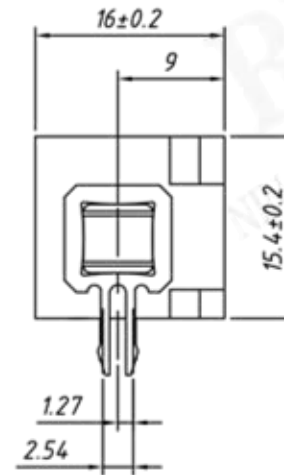

**Material:**  
 Housing: PBT+Glass Filled Polyester  
 Flammability Rating: UL94V-0  
 Contacts: Phosphor Bronze  $\phi 0.46\text{mm}$   
 Plating: Gold Plating  
 PEG: Steel, Tin Plating

**Electrical:**  
 Voltage Rating: 125VAC  
 Current Rating: 1.5A  
 Contact Resistance: 30m $\Omega$  Max.  
 Insulation Resistance: 500M $\Omega$  Min.  
 Dielectric Strength: 1000VAC Rms 50Hz, 1 Min.  
 Durability: 600 cycles Min.  
 Operation Temperature: -40°C ~ +70°C

Order Information

RE-C-303-6P6C-1x5-1-1-XX-B

Contacts: 6P6C  
 Peg Code: 1-With IRON PEG  
 Insert Angle: 1-90°(Right angle)  
 Plating Code:  
 01-Fu" Gold Plating  
 02-3u" Gold Plating  
 03-6u" Gold Plating  
 04-15u" Gold Plating  
 05-30u" Gold Plating  
 Color Code: B-Black  
 G-Gray



NINGBO RHT ELECTRONIC CO.,LTD

UNITS:mm

SHEET SIZE:A4

SCALE:---

>0~3

>3~18

>18~50

>50~120

±0.12

±0.15

±0.3

±0.5

RE-C-303-6P6C-1x5-1-1-XX-B

CONNECTORS

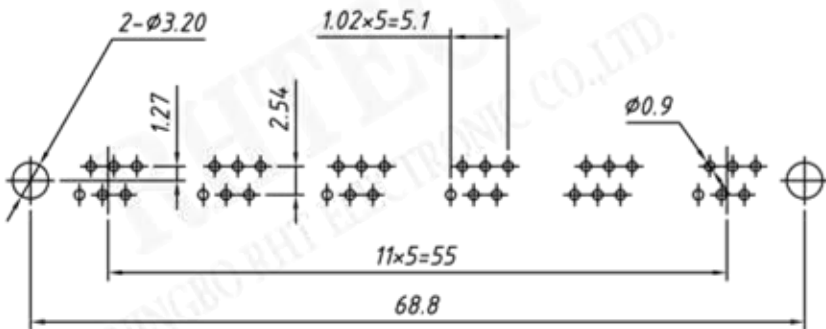
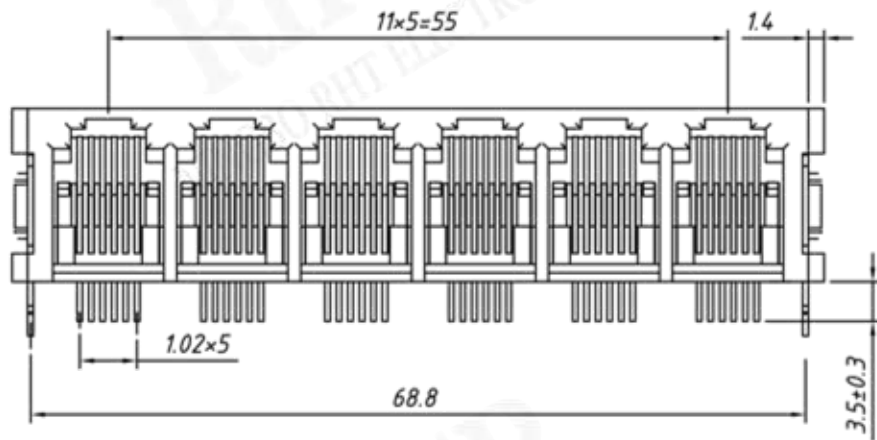
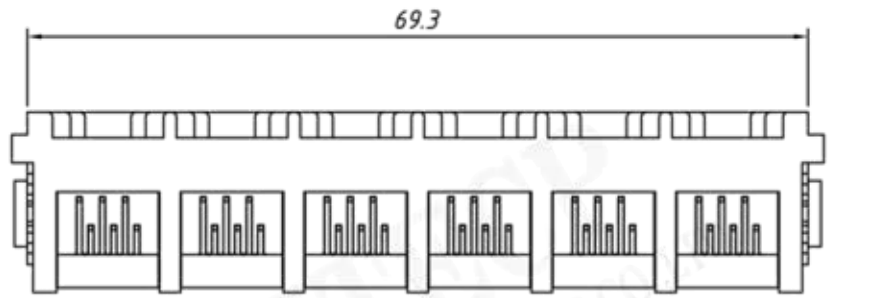

PCB Layout

**Material:**  
**Housing:** PBT+Glass Filled Polyester  
**Flammability Rating:** UL94V-0  
**Contacts:** Phosphor Bronze  $\phi 0.46\text{mm}$   
**Plating:** Gold Plating  
**PEG:** Steel, Tin Plating

**Electrical:**  
**Voltage Rating:** 125VAC  
**Current Rating:** 1.5A  
**Contact Resistance:**  $30\text{m}\Omega$  Max.  
**Insulation Resistance:**  $500\text{M}\Omega$  Min.  
**Dielectric Strength:** 1000VAC Rms 50Hz, 1 Min.  
**Durability:** 600 cycles Min.  
**Operation Temperature:**  $-40^{\circ}\text{C} \sim +70^{\circ}\text{C}$

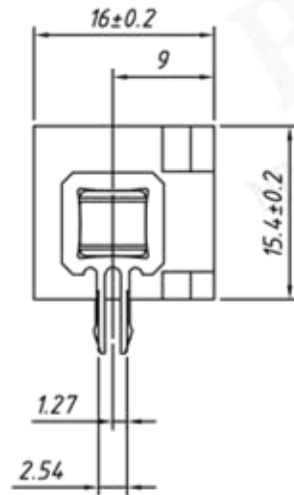

**Order Information**

RE-C-303-6P6C-1x6-1-1-XX-B

**Contacts:** 6P6C  
**Peg Code:** 1-With IRON PEG  
**Insert Angle:** 1-90°(Right angle)  
**Plating Code:**  
 01-Fu" Gold Plating  
 02-3u" Gold Plating  
 03-6u" Gold Plating  
 04-15u" Gold Plating  
 05-30u" Gold Plating  
**Color Code:** B-Black  
 G-Gray

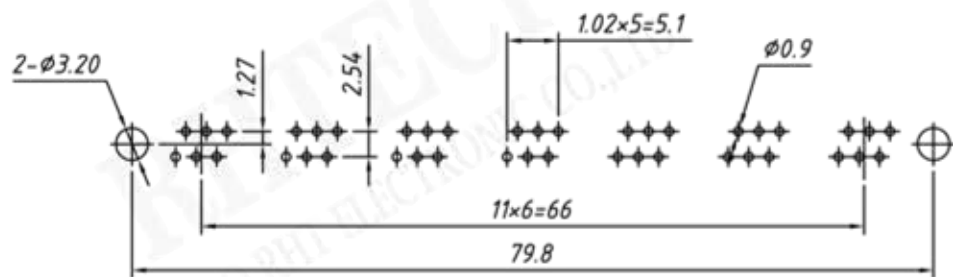
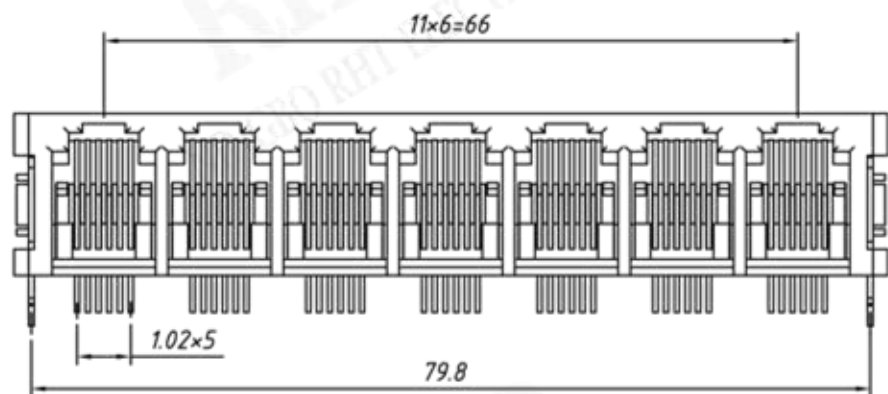
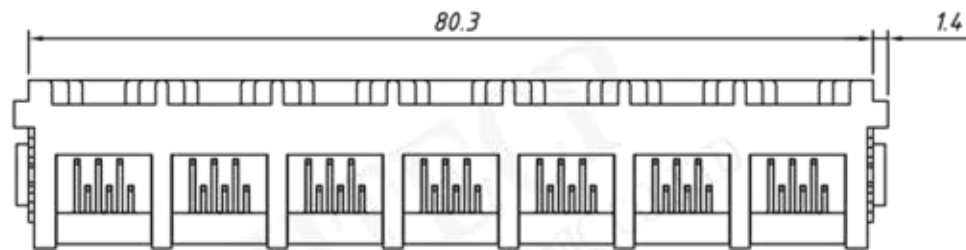

PCB Layout

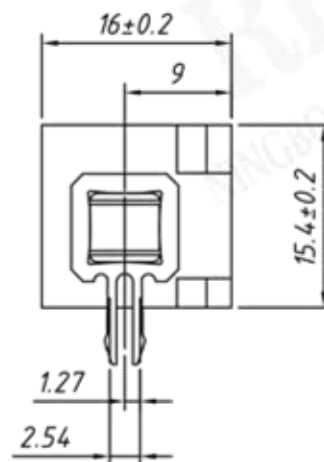

**Material:**  
 Housing: PBT+Glass Filled Polyester  
 Flammability Rating: UL 94V-0  
 Contacts: Phosphor Bronze  $\phi 0.46\text{mm}$   
 Plating: Gold Plating  
 PEG: Steel, Tin Plating

**Electrical:**  
 Voltage Rating: 125VAC  
 Current Rating: 1.5A  
 Contact Resistance: 30m $\Omega$  Max.  
 Insulation Resistance: 500M $\Omega$  Min.  
 Dielectric Strength: 1000VAC Rms 50Hz, 1 Min.  
 Durability: 600 cycles Min.  
 Operation Temperature: -40°C ~ +70°C

**Order Information**

RE-C-303-6P6C-1x7-1-1-XX-B

Contacts: 6P6C  
 Peg Code: 1-With IRON PEG  
 Insert Angle: 1-90°(Right angle)  
 Plating Code:  
 01-Fu" Gold Plating  
 02-3u" Gold Plating  
 03-6u" Gold Plating  
 04-15u" Gold Plating  
 05-30u" Gold Plating  
 Color Code: B-Black  
 G-Gray

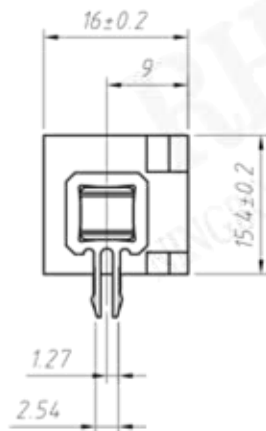
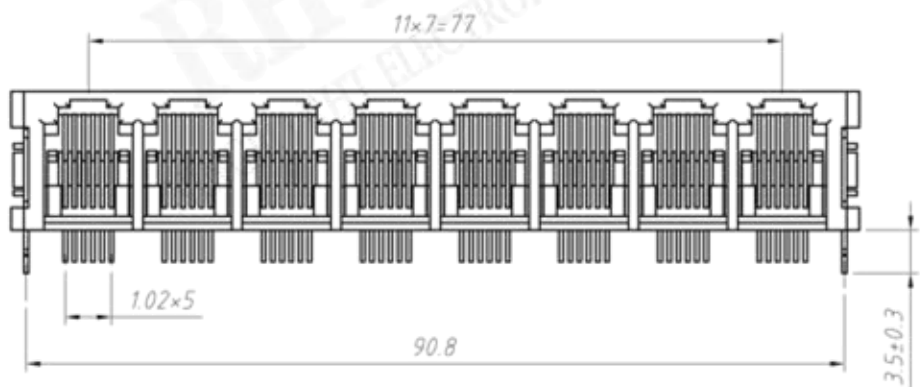
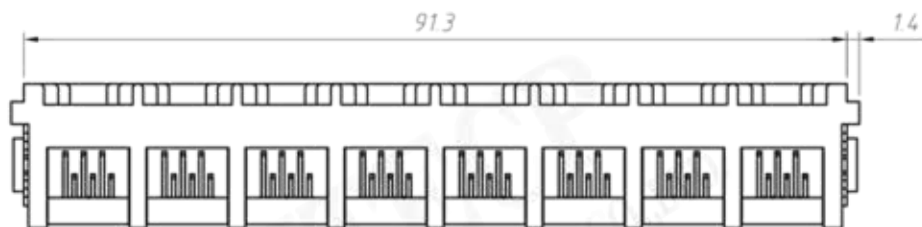

**Material:**  
**Housing:** PBT+Glass Filled Polyester  
**Flammability Rating:** UL94V-0  
**Contacts:** Phosphor Bronze  $\phi 0.46\text{mm}$   
**Plating:** Gold Plating  
**PEG:** Steel, Tin Plating

**Electrical:**  
**Voltage Rating:** 125VAC  
**Current Rating:** 1.5A  
**Contact Resistance:** 30m $\Omega$  Max.  
**Insulation Resistance:** 500M $\Omega$  Min.  
**Dielectric Strength:** 1000VAC Rms 50Hz, 1 Min.  
**Durability:** 600 cycles Min.  
**Operation Temperature:** -40°C ~ +70°C

**Order Information**

RE-C-303-6P6C-1x8-1-1-XX-B

**Contacts:** 6P6C  
**Peg Code:** 1-With IRON PEG  
**Insert Angle:** 1-90°(Right angle)  
**Plating Code:**  
 01-Fu" Gold Plating  
 02-3u" Gold Plating  
 03-6u" Gold Plating  
 04-15u" Gold Plating  
 05-30u" Gold Plating  
**Color Code:** B-Black  
 G-Gray

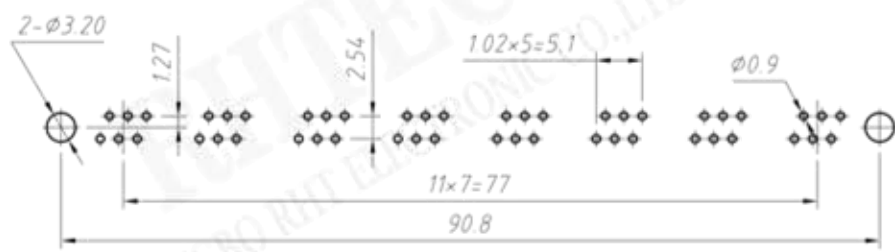

PCB Layout



NINGBO RHT ELECTRONIC CO.,LTD

UNITS:mm	SHEET SIZE:A4	SCALE:---
>0~3	>3~18	>18~50
±0.12	±0.15	±0.3
		±0.5

RE-C-303-6P6C-1x8-1-1-XX-B

CONNECTORS