

## Terminals Series

### RE-C-01104 Circular bare terminal Series

Terminal Material: COPPER

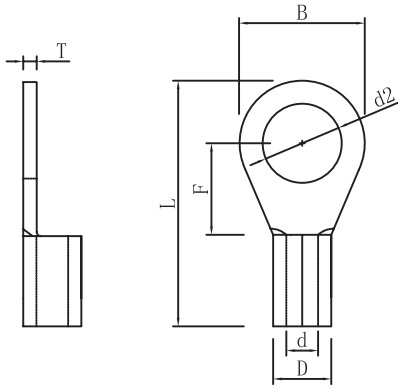

Item No.	Section off ead	Dimension							
		USA BOLTNO	d2 mm	B mm	L mm	F mm	H mm	D mm	d mm
RNB1.25~3	0.5~1.5mm <sup>2</sup> (22~16A.W.G.) I Max=19A	#4	3.2mm	5.7	12.6	4.95	4.8	3.4	1.7
RNBM1.25-3.5		#6	3.7mm	6.6	14.4	6.3			
RNBS1.25-4		#8	4.3mm	6.6	14.4	6.3			
RNBL1.25-4		#8	4.3mm	8.0	15.8	7.0			
RNB1.25-5		#10	5.3mm	8.0	15.8	7.0			
RNB1.25-6		1/4	6.5mm	11.6	21.8	11.1			
RNB1.25-8		5/16	8.4mm	11.6	21.8	11.1			
RNB1.25-10		3/8	10.5mm	13.6	25.5	13.9			
RNB2-3.2	1.5~2.5mm <sup>2</sup> (16~14A.W.G.) I Max=27A	#4	3.2mm	6.6	12.3	4.3	4.8	4.1	2.3
RNBL2-3.5		#6	3.7mm	8.5	16.8	7.75			
RNBS2-3.5		#6	3.7m m	6.6	16.0	7.0			
RNBL2-4		#8	4.3mm	8.5	16.8	7.75			
RNBS2-4		#8	5.3mm	8.5	16.8	7.75			
RNBL2-5		#10	5.3mm	9.5	16.8	7.25			
RNB2-6		#10	6.5mm	12.0	21.8	11.0			
RNB2-8		5/16	8.4mm	12.0	21.8	11.0			
RNB2-10		3/8	10.5mm	13.6	25.5	13.9			

## ORDERINFORMATION

RE-C-01104 - RNB1.25~3

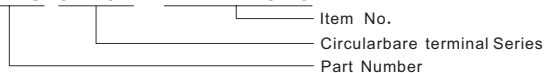



## Terminals Series

### RE-C-01104 Circular bare terminal Series

Item No.	Section of lead	Dimension							
		USA BOLTNO	d2	B	L	F	H	D	d
			mm	mm	mm	mm	mm	mm	mm
RNB3.5-4	2.5~4mm <sup>2</sup> (14~12A.W.G.) I Max=37A	#8	4.3mm	8.0	18.0	7.7	6.0	5.0	3.0
RNBS3.5-5		#10	5.3mm	8.0	18.0	7.7			
RNBL3.5-5		#10	5.3mm	12.0	21.4	7.7			
RNB3.5-6		1/4	6.5mm	12.0	21.4	7.7			
RNBS5.5-3.5	4~6mm <sup>2</sup> (12~10A.W.G.) I Max=48A	#6	3.7mm	7.2mm	15.7mm	5.9mm	6.8	5.6	3.4
RNBL5.5-4		#8	4.3mm	7.2mm	15.7mm	5.9mm			
RNB5.5-4		#8	4.3mm	9.5mm	19.8mm	8.3mm			
RNB5.5-5		#10	5.3mm	9.5mm	19.8mm	8.3mm			
RNB5.5-6		1/4	6.5mm	12mm	25.8mm	13mm			
RNB5.5-8		5/16	8.4mm	15mm	28mm	13.7mm			
RNB5.5-10		3/8	10.5mm	15mm	28mm	13.7mm			
RNB5.5-12		1/2	13.0mm	19.2mm	32.4mm	16mm			
RNB8-4	6~10mm <sup>2</sup> (8A.W.G) I Max=62A	#8	4.3mm	12.0	23.8	9.3	8.5	7.2	4.5
RNBS8-5		#10	5.3mm	8.8	23.8	11.1			
RNBM8-5		#10	5.3mm	12.0	23.8	9.3			
RNBL8-5		#10	5.3mm	15.0	29.8	13.8			
RNBS8-6		1/4	6.5mm	12.0	23.8	9.3			
RNBL8-6		1/4	6.5mm	15.0	29.8	13.8			
RNB8-8		5/16	8.4mm	15.0	29.8	13.8			
RNB8-10		3/8	10.5mm	15.0	29.8	13.8			
RNB14-4	10~16mm <sup>2</sup> (6A.W.G.) I Max=88A	#8	4.3mm	12.0	29.8	13.3	10.5	9.0	5.8
RNB14-5		#10	5.3mm	12.0	29.8	13.3			
RNBS14-6		1/4	6.5mm	12.0	29.8	13.3			
RNBL14-6		1/4	6.5mm	16.0	32.8	13.3			
RNB14-8		5/16	8.4mm	16.0	32.8	14.5			
RNB14-10		3/8	10.5mm	16.0	32.8	14.5			
RNB14-12		1/2	13.0mm	22.0	41.0	19.5			
RNBS22-5	16~25mm <sup>2</sup> (4A.W.G.) I Max=115A	#10	5.3mm	12.2	33.2	14.5	12.0	11.5	7.7
RNBL22-5		#10	5.3mm	16.5	33.7	13.5			
RNBS22-6		1/4	6.5mm	12.2	33.2	14.5			
RNBL22-6		1/4	6.5mm	16.5	33.7	13.5			
RNB22-8		5/16	8.4mm	16.5	33.7	13.5			
RNB22-10		3/8	10.5mm	16.5	33.7	13.5			
RNB22-11		7/16	11.5mm	22.0	42.5	19.5			
RNB22-12		1/2	13.0mm	22.0	42.5	19.5			
RNB35-5	35~50mm <sup>2</sup> (2A.W.G.) I Max=160A	#10	5.3mm	15.3	39.0	18.3	14.0	13.3	9.4
RNB35-6		1/4	6.5mm	15.3	39.0	18.3			
RNBS38-8		1/4	8.4mm	15.3	39.0	18.3			
RNBL38-8		5/16	8.4mm	22.0	42.7	17.7			
RNBS38-10		3/8	10.5mm	15.3	39.0	18.3			
RNBL38-10		7/16	10.5mm	22.0	42.7	17.7			
RNB38-12		1/2	13.0mm	22.0	42.7	17.7			

## ORDER INFORMATION

RE-C-01104 - RNB1.25~3

